

1 What You Need

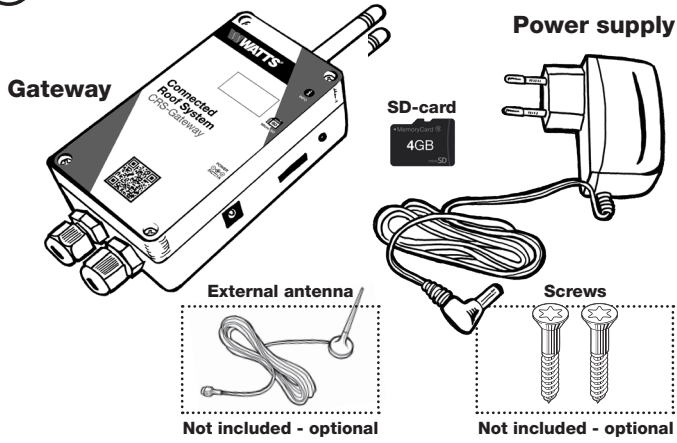

2 Location

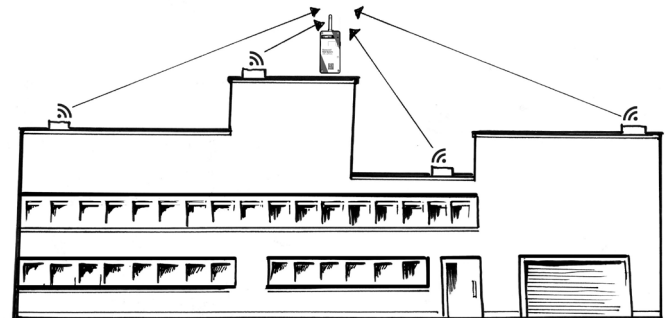

Place Gateway central and in line of sight

3 Installation Conditions

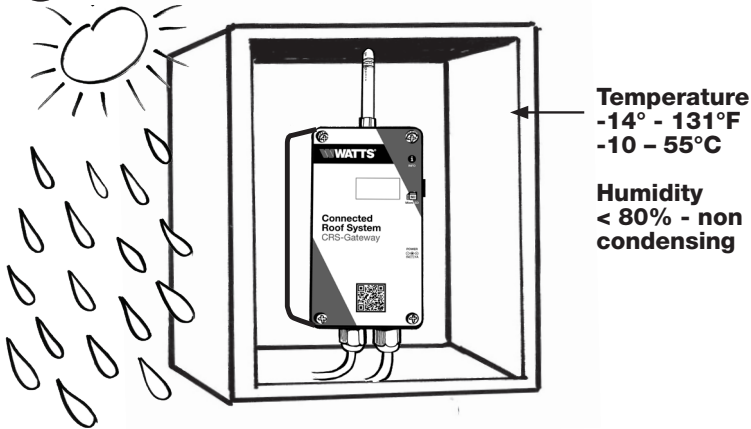

4 Access Requirements

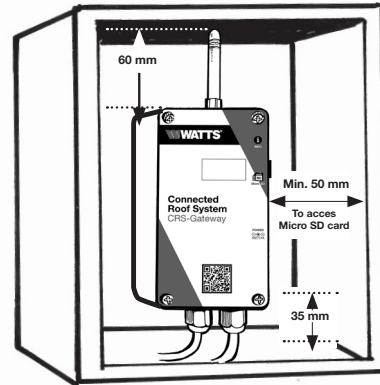

5 Mounting

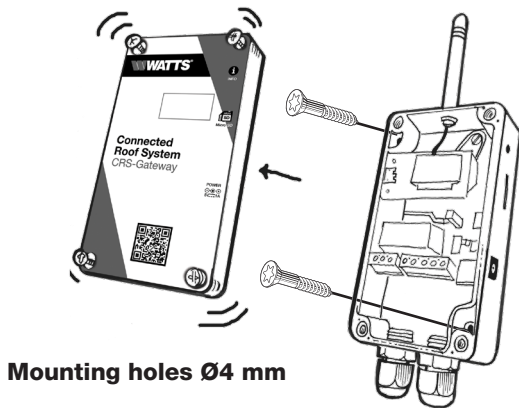

6 Configure Gateway

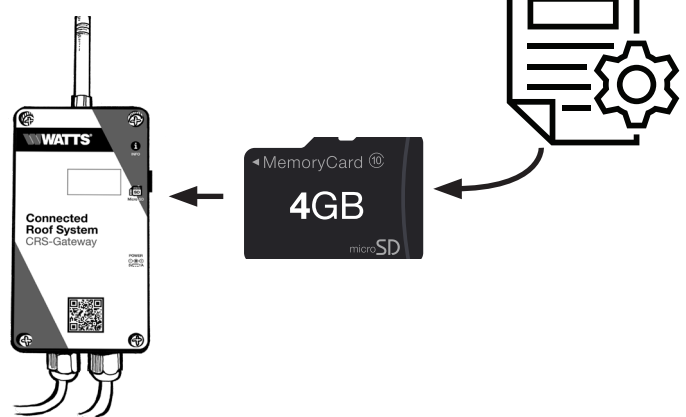

7a Connect Power

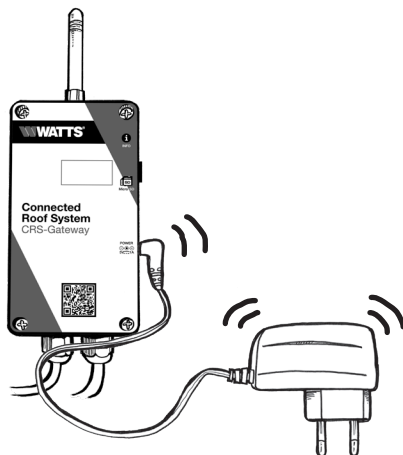

7b Internal Power Connection (optional)

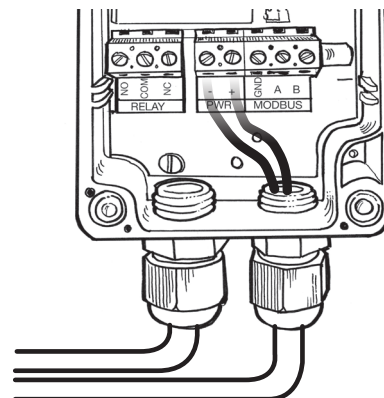

Connected Roof Gateway



WATTS

NOTICE

The information contained herein is not intended to replace the full product installation and safety information available or the experience of a trained product installer. You are required to thoroughly read all installation instructions for this product; safety information before beginning the installation of this product.

WATTS

USA: T: (978) 689-6066 • F: (978) 975-8360 • Watts.com
 Canada: T: (888) 208-8927 • F: (905) 332-7088 • Watts.ca
 Latin America: T: (52) 55-4122-0138 • Watts.com
 OG-WD-CR-Gateway 2124 EDP#1926060 © 2021 Watts

8a) Wait and Verify

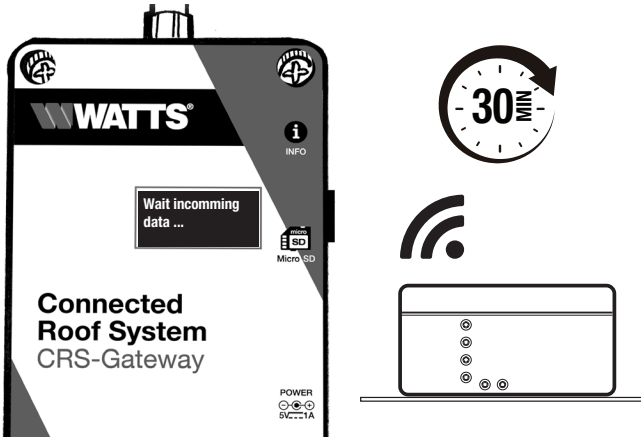

8b) Speed Up and Verify

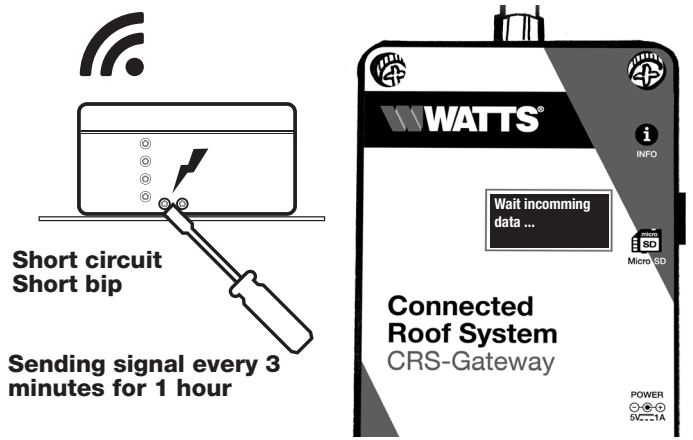

9) Verify Monitor Connection

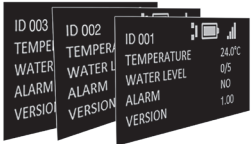
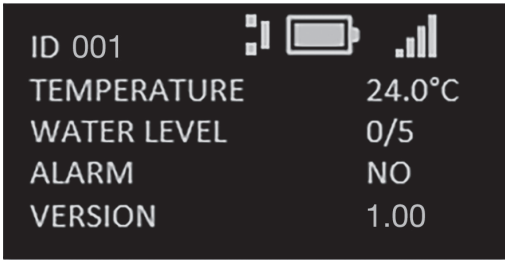

Confirm all monitors

10) Relay and Modbus

See Installation guide

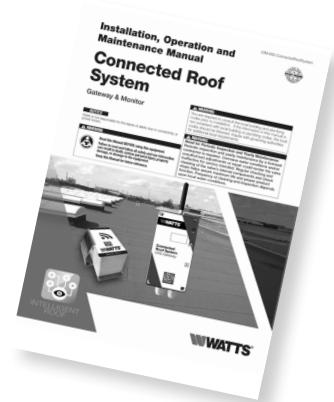

11) Modbus (RS-485)

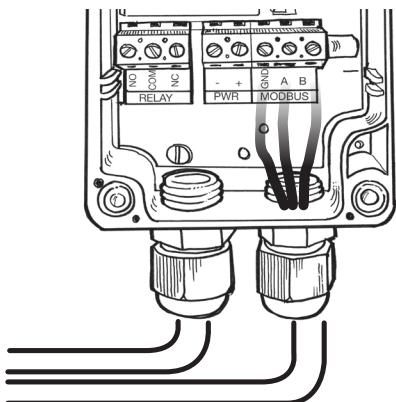

12) Relay

