

SPECIFICATIONS

FLOAT AND THERMOSTATIC

BODY AND COVER: CAST IRON 30,000 PSI TENSILE

VALVE PIN AND SEAT: STAINLESS STEEL (HARDENED)

FLOAT: STAINLESS STEEL

LEVER ASSEMBLY: STAINLESS STEEL

THERMOSTATIC AIR VENT: STAINLESS STEEL CAGE AND THERMAL ELEMENT

COVER BOLTS: GRADE 5

DIMENSIONS in (mm)

| PART # | CONN. SIZE (IN.) | A | B | C | D | E | F | G | H | J | WEIGHT LBS (KG) |
|--------------------|------------------|--------------|--------------|--------------|---------------|--------------|------------|------------|--------------|------------|-----------------|
| 99136-4 | 1-1/2 | 4-1/4 (108) | 8-5/16 (211) | 8-9/16 (217) | 3 (76) | 3-3/8 (86) | 2 (51) | | 45/64 (17.8) | 1-3/8 (35) | 18 (8) |
| 99136-5 | 2 | 7-3/16 (183) | 10-1/8 (257) | 10-1/2 (267) | 4-15/16 (379) | 2-11/16 (68) | 3-1/4 (83) | 1/2 (12.7) | 1/8 (3.2) | | 33 (15) |
| 99136-6 (SEE NOTE) | 2 | 10 (254) | 15 (381) | 15-1/2 (394) | 6-5/8 (168) | 4-3/4 (121) | 3-1/2 (89) | | | | 108 (49) |

Capacities (Gross Ratings)

| PART # | CONNECTION SIZE in. | ORIFICE SIZE in. (mm) | Pressure Differential in Pounds Per Square Inch (bar) | | | | |
|--------------------|---------------------|-----------------------|---|-------------|-------------|-------------|--------------|
| | | | 1/4 (0.017) | 1/2 (0.035) | 1 (0.07) | 2 (0.14) | 5 (0.35) |
| | | | Capacities in Pounds of Condensate Per Hour (kg/hr) | | | | |
| 99136-4 | 1-1/2 | .390 (10) | 1000 (450) | 1300 (590) | 1700 (770) | 2300 (1040) | 3400 (1540) |
| 99136-5 | 2 | .563 (14) | 1700 (771) | 2500 (1134) | 3100 (1406) | 4100 (1859) | 5800 (2630) |
| 99136-6 (SEE NOTE) | 2 | .876 (22) | 3400 (1543) | 4600 (2088) | 6400 (2905) | 8400 (3813) | 12500 (5675) |

Selection Guide:

- Maximum steam pressure TO THE CONTROL VALVE = 30 PSIG.
- Select the Trap based on the following Pressure Differentials and Factor of Safety:

| Steam Pressure TO HEAT EXCHANGER (OUTLET of Control Valve) | Pressure Differential to Use for Steam Trap Selection | Factor of Safety to Use for Steam Trap Selection |
|--|---|--|
| up to 15 psi | 1/2 psi (1-1/2" SIZE) 1 psi (2" SIZE) | 1.5 |
| 16 - 25 psi | 5 psi | 1.5 |

- See document A701.2 for quick selection charts with appropriate pressure differentials and factor of safety already applied.

IMPORTANT:

- Discharge piping from the steam trap must drain by gravity/downhill to atmosphere or vented receiver.
- Do NOT drain to condensate return system or any system that will cause lift/backpressure.

99136-4

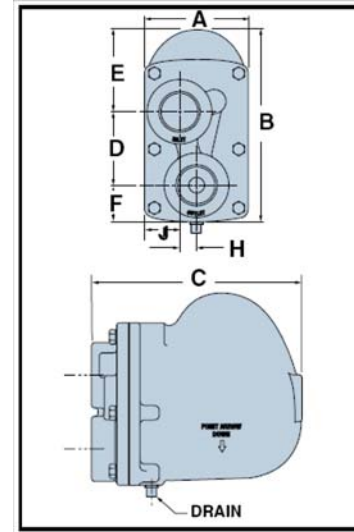

99136-5

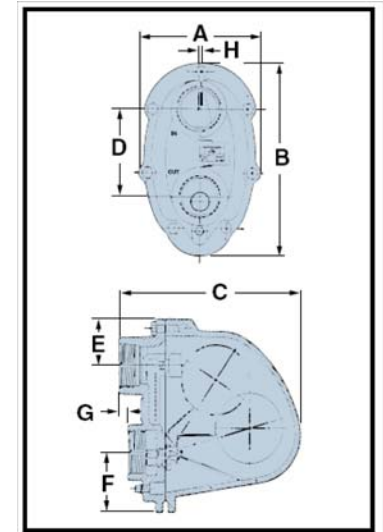

99136-6 (SEE NOTE)

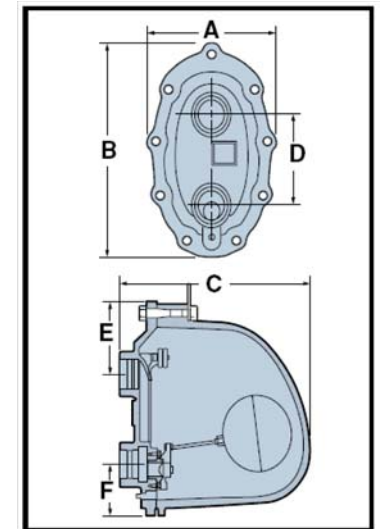

NOTE:

The inlet connection of 99136-6 is vertically higher (~10.25") than the condensate outlet of the SWDW24 (~9"). The SWDW24 must be installed on a concrete pad to accommodate this trap.

AERCO INTERNATIONAL, INC.
NORTHVALE, NJ 07647

MAIN CONDENSATE TRAP 30 PSI
FLOAT AND THERMOSTATIC

DWN.BY CZ DATE 093010
SCALE _____ SIZE _____
CHKD. _____ APPD. _____
REV. DATE _____

AP-A-883

REV. **A**